

PRESSURE

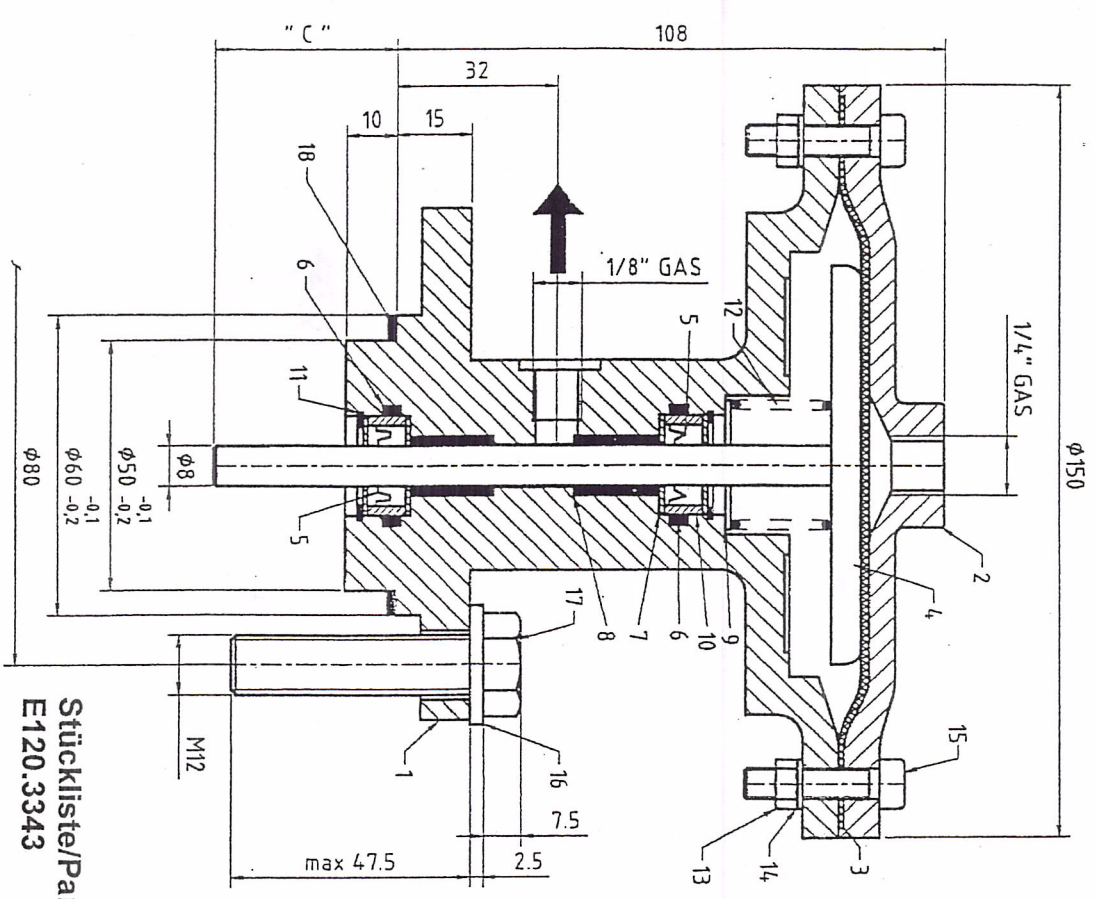

Stückliste/Part List:
E120.3343

REV.	DESCRIZIONE	DATA
0	EMISSIONE	02.10.01
1	ADDED CODE (A) - (B) IT WAS M32789 - (C) IT WAS VEX	01.03.02
2	(D) QUANTITY FROM 1 TO 2 - (E) QUANTITY FROM 3 TO 4	25-03-02
3	(F) ADDED CODES	30-09-02
4	(G) ADDED CODES	19.02.03

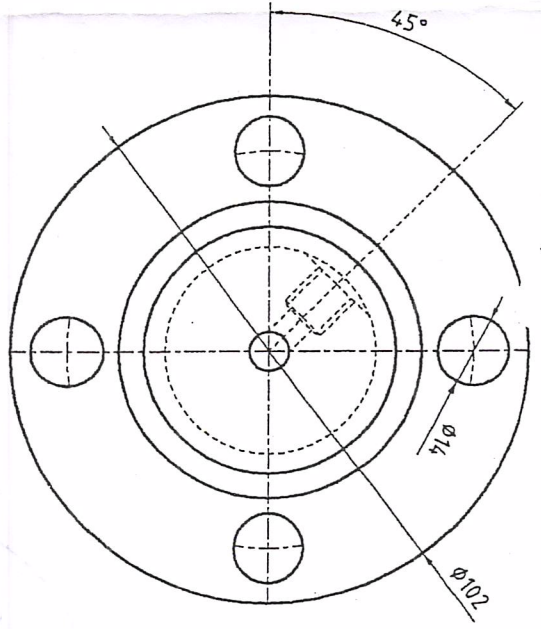

302-C

GB-302C

RIF.	DESCRIPTION	CODE	DIMENSION "C"	DRAWING CODE
(G) 4	ASSEMBLY PISTON			
(F) 4	ASSEMBLY PISTON			
(F) 4	ASSEMBLY PISTON			
(A) 4	ASSEMBLY PISTON			

(C) 17	BOLT	4		INOX A2-70
16	WASHER	4		INOX
15	SCREW	8		STEEL
14	WASHER	8		STAINLESSSTEEL
13	NUT	8		STEEL
(B) 12	SPRING	1		ALSI 316
(D) 11	SEGER	2		X35CrMo17
10	WASHER	2		X30Cr13
9	WASHER	1		7Cr21Mo2
8	BUSH	2		BRONZE
7	WASHER	4		7Cr21Mo2
6	O-RING	2		NBR
5	GASKET	2		NBR
4	ASSEMBLY PISTON	1		-
3	MEMBRANE	1		X30Cr13
2	UPPER PART	1		X30Cr13
1	LOWER PART	1		X30Cr13
RIF.	DESCRIPTION	N.	CODE	MATERIAL

UNLOADER SYSTEM: SCM/75

PREP.	CONTR.	APPR.	SCALA
ML	DS	KE	-

DOTT.ING.MARIO COZZANI S.r.l.

LA SPEZIA - ITALY

E120.3342

CLIENTE NEA

QUESTO DISEGNO E' PROPRIETA' DI DOTT.ING.MARIO COZZANI S.r.l. A TITOLAZIONE DI LICENZA D'USO. TUTTI I DIRITTI SONO RISERVATI. IL REPLICARE IL PRESENTE DOCUMENTO E' PROIBITO. IL REPLICARE IL PRESENTE DOCUMENTO E' PROIBITO. IL REPLICARE IL PRESENTE DOCUMENTO E' PROIBITO.